

Sheaves

6TC/Split Taper

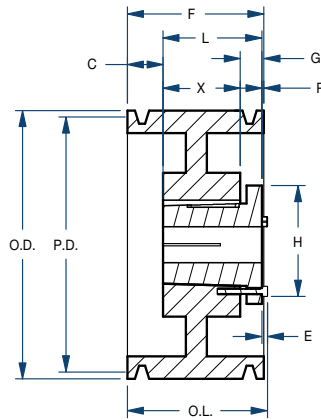

BLACKSTAR®



Type 15

Part Number		Diameters (in)		Type	Dimensions (in)									Weight less Bushing (lbs)
Sheave	Bushing	Pitch	Outside		O.L.	L	P	C	H	F	G	X	E	
6TC70	Q2	7.0	7.40	15	6-1/4	3-1/2	1	1-3/4	4-1/8	6-1/4	3/4	2-3/4	9/32	29.9
6TC72	Q2	7.2	7.60	15	6-1/4	3-1/2	1	1-3/4	4-1/8	6-1/4	3/4	2-3/4	9/32	33.6
6TC74	Q2	7.4	7.80	15	6-1/4	3-1/2	1	1-3/4	4-1/8	6-1/4	3/4	2-3/4	9/32	33.3
6TC76	Q2	7.6	8.00	15	6-1/4	3-1/2	1	1-3/4	4-1/8	6-1/4	3/4	2-3/4	9/32	37.9
6TC78	Q2	7.8	8.20	15	6-1/4	3-1/2	1	1-3/4	4-1/8	6-1/4	3/4	2-3/4	9/32	33.5
6TC80	Q2	8.0	8.40	15	6-1/4	3-1/2	1	1-3/4	4-1/8	6-1/4	3/4	2-3/4	9/32	37.6
6TC82	Q2	8.2	8.60	15	6-1/4	3-1/2	1	1-3/4	4-1/8	6-1/4	3/4	2-3/4	9/32	34.0
6TC84	Q2	8.4	8.80	15	6-1/4	3-1/2	1	1-3/4	4-1/8	6-1/4	3/4	2-3/4	9/32	37.0
6TC86	Q2	8.6	9.00	15	6-1/4	3-1/2	1	1-3/4	4-1/8	6-1/4	3/4	2-3/4	9/32	35.0
6TC88	Q2	8.8	9.20	15	6-1/4	3-1/2	1	1-3/4	4-1/8	6-1/4	3/4	2-3/4	9/32	39.4
6TC90	Q2	9.0	9.40	15	6-1/4	3-1/2	1	1-3/4	4-1/8	6-1/4	3/4	2-3/4	9/32	36.8
6TC92	Q2	9.2	9.60	15	6-1/4	3-1/2	1	1-3/4	4-1/8	6-1/4	3/4	2-3/4	9/32	41.0
6TC94	Q2	9.4	9.80	15	6-1/4	3-1/2	1	1-3/4	4-1/8	6-1/4	3/4	2-3/4	9/32	39.4
6TC96	Q2	9.6	10.00	15	6-1/4	3-1/2	1	1-3/4	4-1/8	6-1/4	3/4	2-3/4	9/32	43.6
6TC98	Q2	9.8	10.20	15	6-1/4	3-1/2	1	1-3/4	4-1/8	6-1/4	3/4	2-3/4	9/32	42.0
6TC100	Q2	10.0	10.40	15	6-1/4	3-1/2	1	1-3/4	4-1/8	6-1/4	3/4	2-3/4	9/32	47.3
6TC102	Q2	10.2	10.60	15	6-1/4	3-1/2	1	1-3/4	4-1/8	6-1/4	3/4	2-3/4	9/32	44.4
6TC106	Q2	10.6	11.00	15	6-1/4	3-1/2	1	1-3/4	4-1/8	6-1/4	3/4	2-3/4	9/32	45.4
6TC110	Q2	11.0	11.40	15	6-1/4	3-1/2	1	1-3/4	4-1/8	6-1/4	3/4	2-3/4	9/32	47.0
6TC114	Q2	11.4	11.80	15	6-1/4	3-1/2	1	1-3/4	4-1/8	6-1/4	3/4	2-3/4	9/32	49.6
6TC120	Q2	12.0	12.40	15	6-1/4	3-1/2	1	1-3/4	4-1/8	6-1/4	3/4	2-3/4	9/32	51.0
6TC130	Q2	13.0	13.40	15	6-1/4	3-1/2	1	1-3/4	4-1/8	6-1/4	3/4	2-3/4	9/32	56.0
6TC160	Q2	16.0	16.40	15	6-1/4	3-1/2	1	1-3/4	4-1/8	6-1/4	3/4	2-3/4	9/32	72.0
6TC200	Q2	20.0	20.40	15	6-1/4	3-1/2	1	1-3/4	4-1/8	6-1/4	3/4	2-3/4	9/32	88.3
6TC240	Q2	24.0	24.40	15	6-1/4	3-1/2	1	1-3/4	4-1/8	6-1/4	3/4	2-3/4	9/32	108.0